

\$729,900 - 2096 Graydon Hill Crescent, Edmonton

MLS® #E4429113

\$729,900

7 Bedroom, 4.00 Bathroom, 2,210 sqft
Single Family on 0.00 Acres

Graydon Hill, Edmonton, AB

Discover luxury living in Graydon Hill with this stunning 7-BEDROOM home, featuring high-end finishes, an OPEN TO ABOVE design, and a bright kitchen with a SPICE KITCHEN. The MAIN FLOOR includes a BEDROOM and FULL BATH, while upgraded triple-pane windows enhance comfort. The BASEMENT offers a LEGAL 2-BEDROOM SUITE with a private entrance, perfect for rental income or extended family. Enjoy quartz countertops, included appliances, and a master suite with a spa-like 5-piece ensuite. Close to amenities, scenic trails, and green spaces, this move-in-ready home is an exceptional opportunity!

Built in 2022

Essential Information

MLS® #	E4429113
Price	\$729,900
Bedrooms	7
Bathrooms	4.00
Full Baths	4
Square Footage	2,210
Acres	0.00
Year Built	2022
Type	Single Family
Sub-Type	Detached Single Family

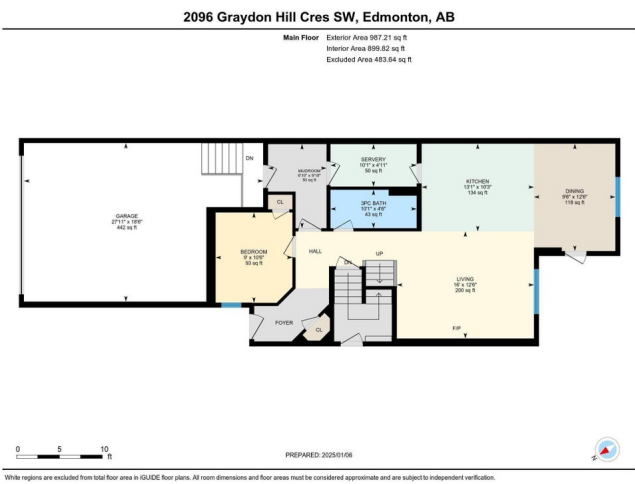
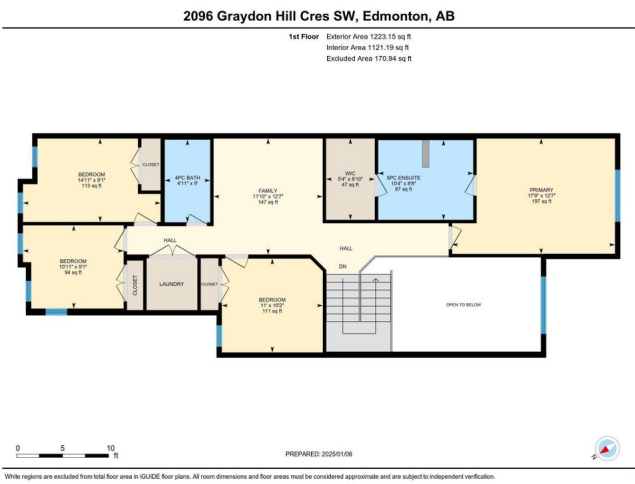

Style	2 Storey
Status	Active

Community Information

Address	2096 Graydon Hill Crescent
Area	Edmonton
Subdivision	Graydon Hill
City	Edmonton
County	ALBERTA
Province	AB
Postal Code	T6W 4K6

Amenities

Amenities	See Remarks
Parking	Double Garage Attached

Interior

Interior Features	ensuite bathroom
Appliances	Dishwasher-Built-In, Hood Fan, Stove-Gas, Dryer-Two, Refrigerators-Two, Stoves-Two, Washers-Two
Heating	Forced Air-2, Natural Gas
Stories	2
Has Suite	Yes
Has Basement	Yes
Basement	Full, Finished

Exterior

Exterior	Wood, Vinyl
Exterior Features	Golf Nearby, Schools, Shopping Nearby
Roof	Asphalt Shingles
Construction	Wood, Vinyl
Foundation	Concrete Perimeter

Additional Information

Date Listed	April 4th, 2025
Days on Market	24
Zoning	Zone 55

DATA IS DEEMED RELIABLE BUT IS NOT GUARANTEED ACCURATE BY THE REALTORS® ASSOCIATION OF EDMONTON. COPYRIGHT 2025 BY THE REALTORS® ASSOCIATION OF EDMONTON. ALL RIGHTS RESERVED. Trademarks are owned or controlled by the Canadian Real Estate Association (CREA) and identify real

estate professionals who are members of CREA (REALTOR®®, REALTORS®®) and/or the quality of services they provide (MLS®®, Multiple Listing Service®®)

Listing information last updated on April 28th, 2025 at 5:17am MDT